

FOR SUBLEASE

±2,560 SF INDUSTRIAL/FLEX UNIT

22607 LA PALMA AVE | SUITE 409 | YORBA LINDA | CA



PROPERTY FEATURES

- ± 1,736 SF of Full-Height Warehouse
- One (1) Ground Level Door
- 18' Warehouse Clearance (Verify)
- 200 Amps (Verify)
- Office furniture can be included
- Professionally Managed Business Park
- Sublease Expiration: December 31, 2025

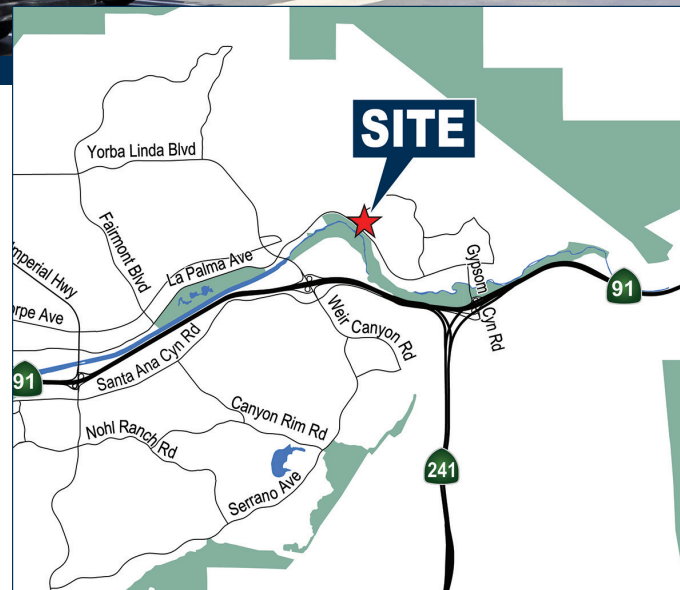

SHANE MITCHELL

Associate

949.263.5318

smitchell@voitco.com

Lic. #02158130

RYAN OSTERKAMP

Associate

949.263.5324

rosterkamp@voitco.com

Lic. #02194839



2020 Main Street, Suite 100 | Irvine, California 92614 | (949) 851-5100 | (949) 261-9092 FAX | Lic #01991785 | www.VoitCo.com

The information contained herein has been obtained from sources we deem reliable. While we have no reason to doubt its accuracy, we do not guarantee it. Licensed as Real Estate Salespersons by the DRE.
©2023 Voit Real Estate Services, Inc. All Rights Reserved. License #01991785.



SHANE MITCHELL

Associate
949.263.5318
smitchell@voitco.com
Lic. #02158130

RYAN OSTERKAMP

Associate
949.263.5324
rosterkamp@voitco.com
Lic. #02194839



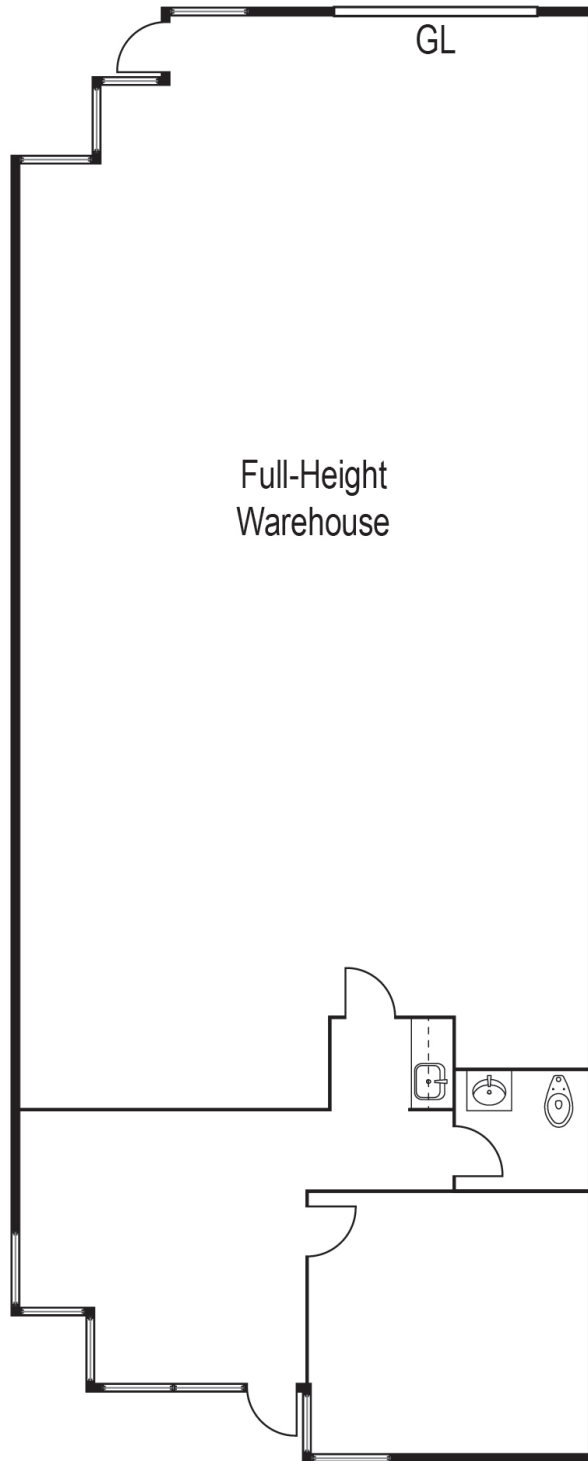

SHANE MITCHELL

Associate
949.263.5318
smitchell@voitco.com
Lic. #02158130

RYAN OSTERKAMP

Associate
949.263.5324
rosterkamp@voitco.com
Lic. #02194839

