

±3,140 SF FOR LEASE

# TURNER INDUSTRIAL PARK

10885 - 10925 KALAMA RIVER | FOUNTAIN VALLEY, CA



## PROPERTY FEATURES

- » Units from 1,752 - 7,154 SF
- » Ground Level Loading
- » 14' Warehouse Clearance
- » Ample Parking
- » Completely Renovated
- » Drive Around Building

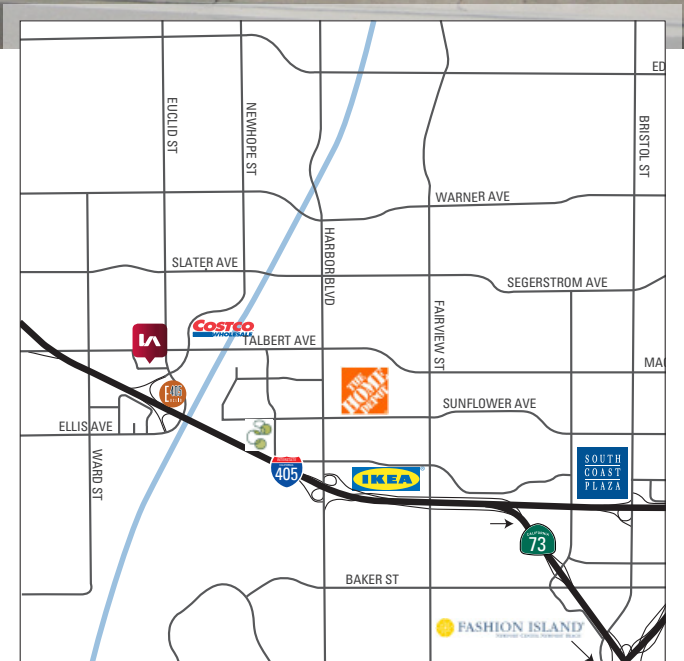

## CONTACT US

JOHN MARTIN  
(949) 724-4701  
john@lee-associates.com  
DRE# 01346629

CHRIS COYTE  
(949) 724-4747  
ccoyle@lee-associates.com  
DRE# 01017328

 **LEE &  
ASSOCIATES**  
**NEWPORT BEACH**

DISCLAIMER: The information contained herein has been obtained from the property owner or other third party and is provided to you without verification as to accuracy. We (Lee & Associates, its brokers, employees, agents, principals, officers, directors and affiliates) make no warranty or representation regarding the information, property, or transaction. You and your attorneys, advisors and consultants should conduct your own investigation of the property and transaction.

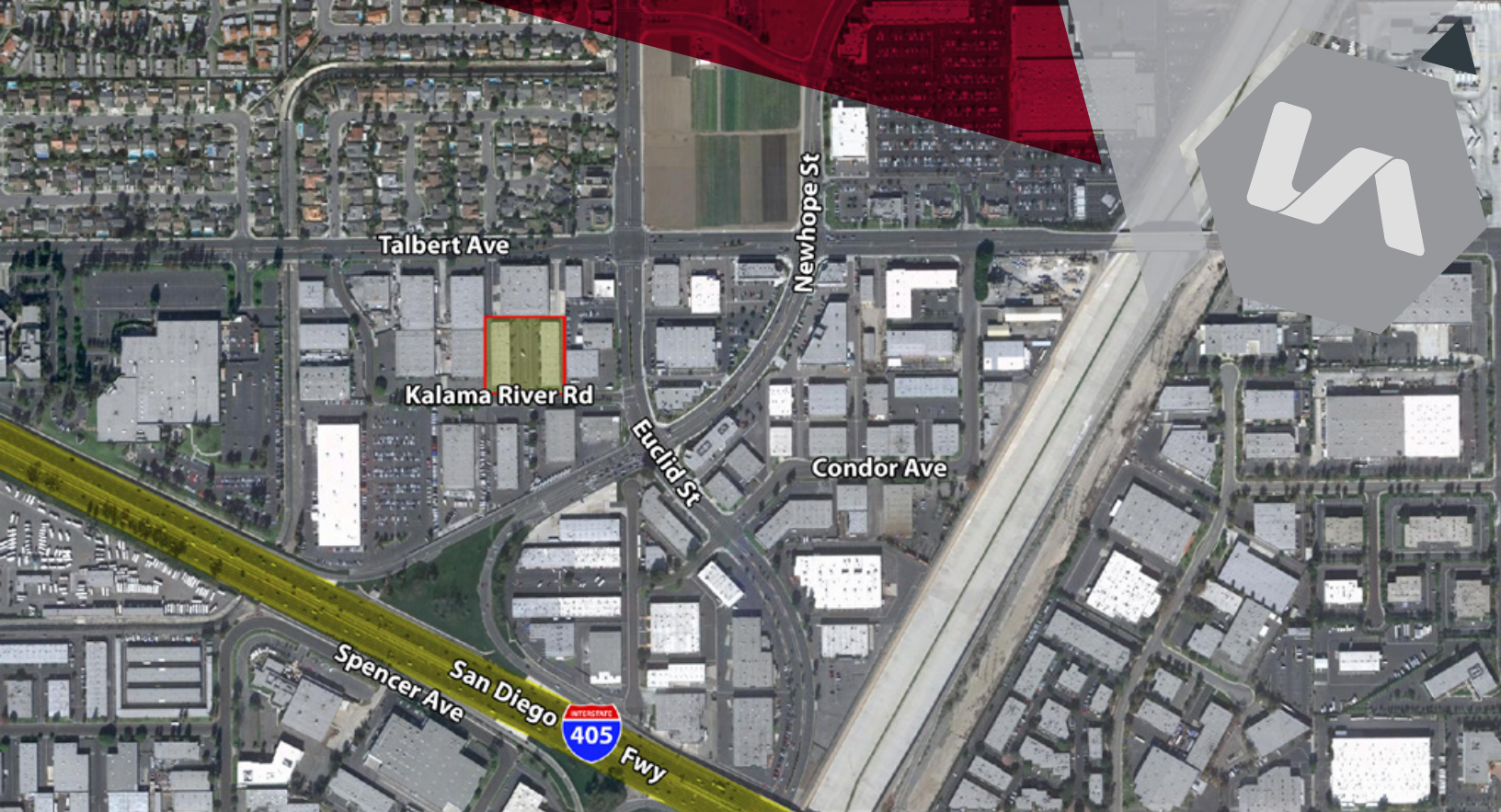

## CURRENT AVAILABILITY

ADDRESS	UNIT	UNIT SIZE	OFFICE SIZE	OFFICE(S)	RESTROOM	GL DOOR	DATE AVAIL.	RATE
10925 Kalama River	K	3,140	±800	One	Two	One	September 1, 2021	\$1.20 IG

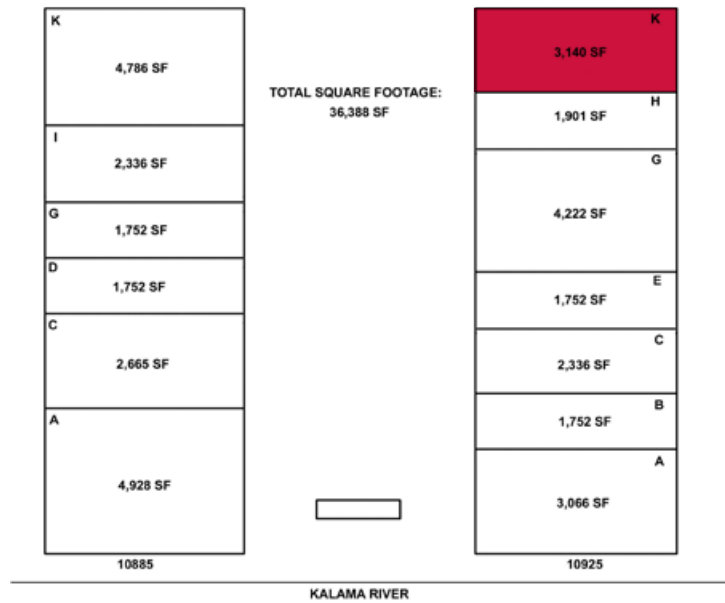

## CONTACT US

JOHN MARTIN  
 (949) 724-4701  
 john@lee-associates.com  
 DRE# 01346629

CHRIS COYTE  
 (949) 724-4747  
 ccoyte@lee-associates.com  
 DRE# 01017328



DISCLAIMER: The information contained herein has been obtained from the property owner or other third party and is provided to you without verification as to accuracy. We (Lee & Associates, its brokers, employees, agents, principals, officers, directors and affiliates) make no warranty or representation regarding the information, property, or transaction. You and your attorneys, advisors and consultants should conduct your own investigation of the property and transaction.

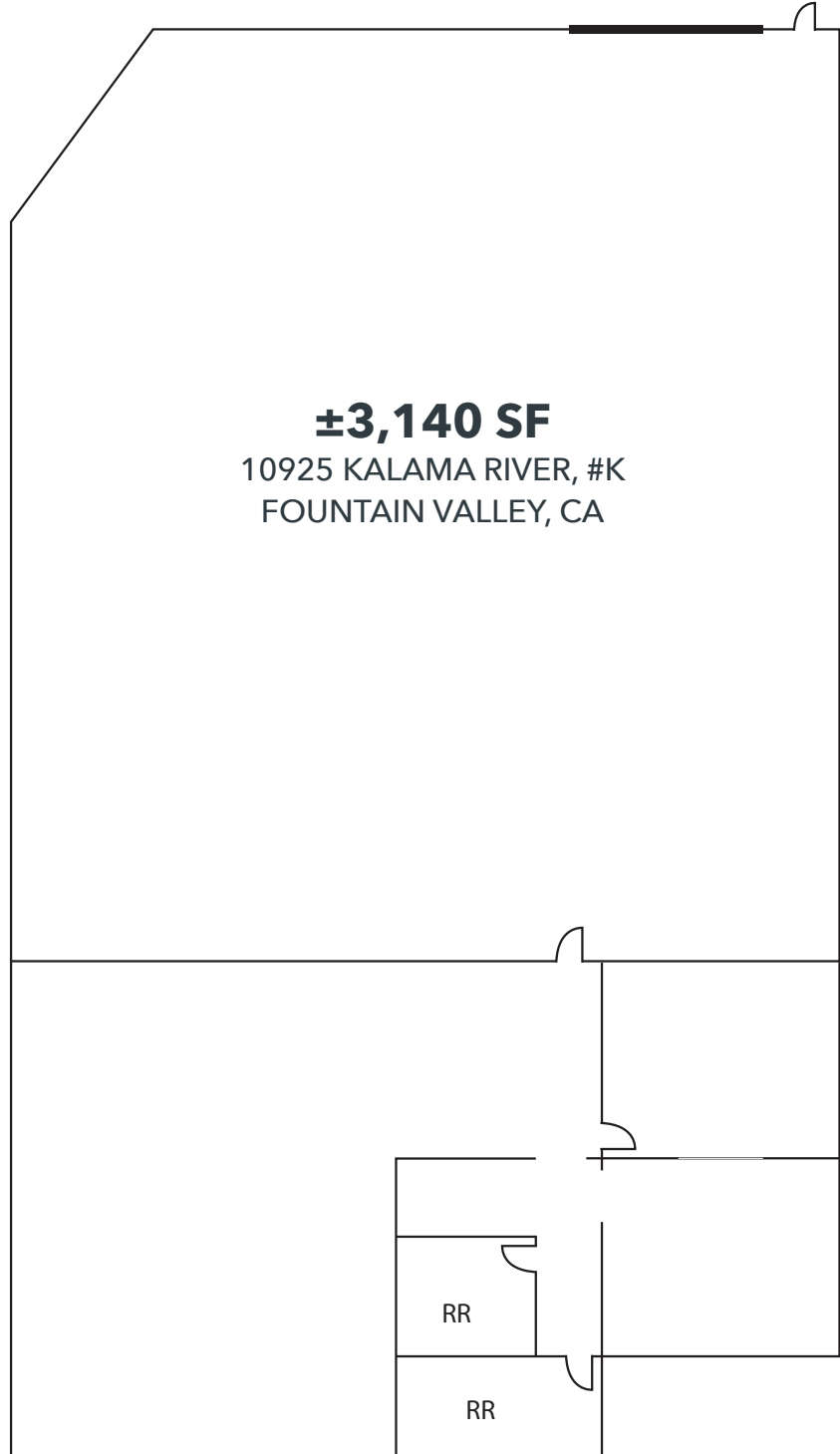

**CONTACT US**

JOHN MARTIN  
(949) 724-4701  
john@lee-associates.com  
DRE# 01346629

CHRIS COYTE  
(949) 724-4747  
ccoyle@lee-associates.com  
DRE# 01017328



DISCLAIMER: The information contained herein has been obtained from the property owner or other third party and is provided to you without verification as to accuracy. We (Lee & Associates, its brokers, employees, agents, principals, officers, directors and affiliates) make no warranty or representation regarding the information, property, or transaction. You and your attorneys, advisors and consultants should conduct your own investigation of the property and transaction.