

FOR LEASE
PROFESSIONAL OFFICE/
MEDICAL SPACE

UNDER NEW OWNERSHIP



TOWER OFFICE PLAZA

27555 YNEZ ROAD | TEMECULA, CA 92591

PROPERTY HIGHLIGHTS

- Tower Office Plaza is an iconic Class A office building that offers unparalleled visibility from the I-15 freeway and Rancho California Road
- Beautiful courtyard setting overlooking serene water feature offering a dramatic and prestigious first impression
- Within walking distance to various retail, professional and restaurant amenities
- High speed data transfer available via fiber optics communications network
- Flexible to accommodate medical and professional users due to extensive in-place wet and dry utility distribution
- Multi-level parking structure provides abundant parking at a ratio of 4 stalls per 1,000 SF of rentable space
- Capital improvement plan in progress
- Highly improved move-in ready office and medical suites available from approximately 1,851 SF.

TOWER OFFICE PLAZA

27555 YNEZ ROAD | TEMECULA, CA 92591



AVAILABILITY

TOWER OFFICE PLAZA

27555 YNEZ ROAD | TEMECULA, CA 92591

SUITE 200	1,923 RSF	\$2.35 MG*	5 private offices, large conference room, coffee bar and storage
SUITE 202	1,851 RSF	\$2.35 MG*	Large reception, conference room, three private offices, breakroom, and storage. Available Immediately

* MG - Tenant pays separately metered electricity and janitorial service separately.

Rev 11/3/2025

Medical Rates start at \$2.75psf with minimum 5 year term.

Tenant Improvement Allowance subject to deal specific terms and Tenant creditworthiness.



SECOND FLOOR

TOWER OFFICE PLAZA

27555 YNEZ ROAD | TEMECULA, CA 92591

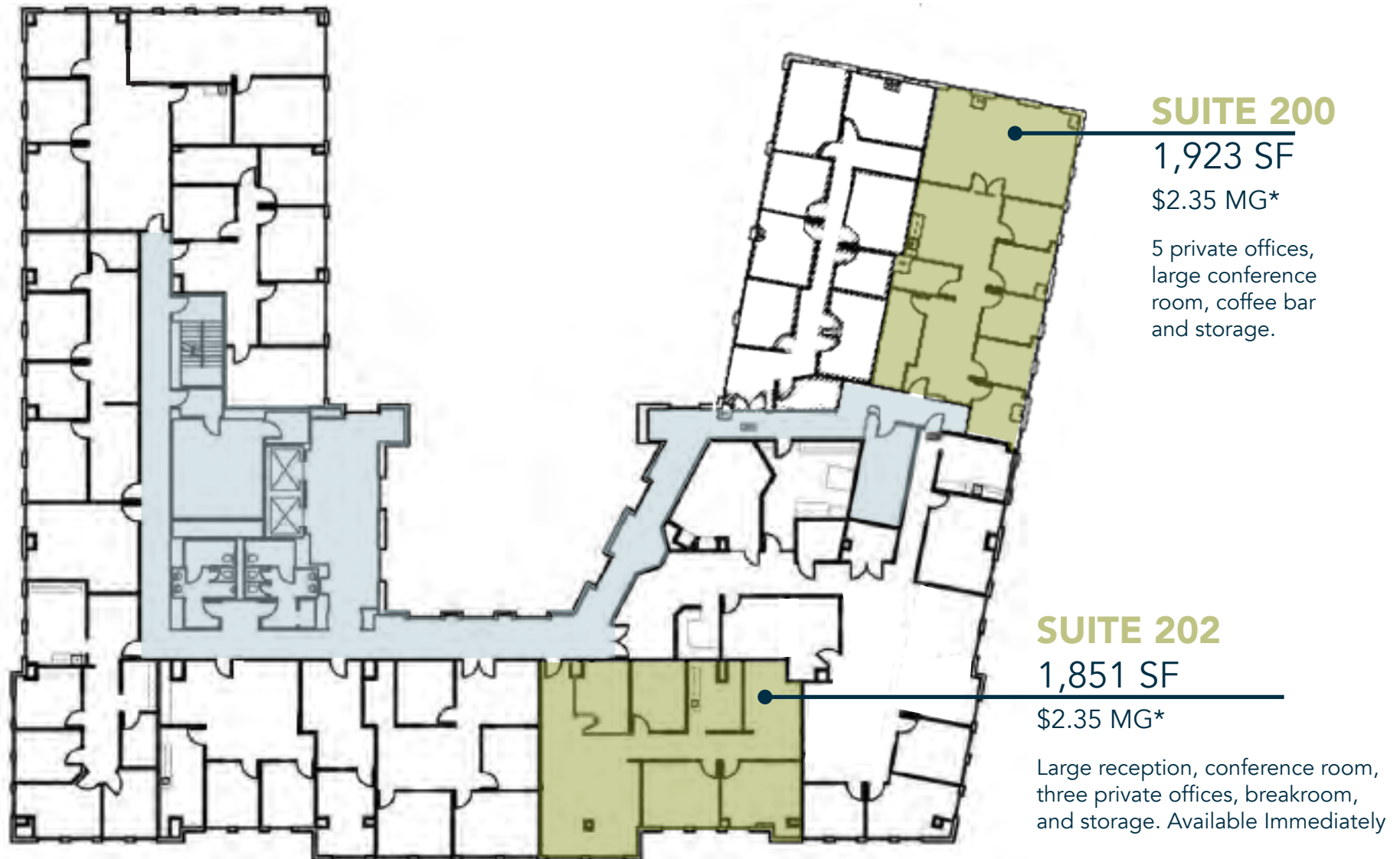

TOWER OFFICE PLAZA

27555 YNEZ ROAD | TEMECULA, CA 92591



MATT SHAW, CCIM

Vice President

951.445.4502

mshaw@leetemecula.com

DRE# 01917622

BLAKE VALDEZ

Vice President

951.445.4509

bvaldez@leetemecula.com

DRE# 02107941



No warranty or representation has been made to the accuracy of the foregoing information. Terms of sale or lease and availability are subject to change or withdrawal without notice. Lee & Associates Commercial Real Estate Services, Inc. - Riverside. 25240 Hancock Avenue, Suite 100 - Murrieta, CA 92562 | Corporate ID# 01048055