



# DESERT HILLS PLAZA

57252 Twentynine Palms Highway, Yucca Valley, CA 92284

**LAST JUNIOR ANCHOR SPACE**  
±12,572 SF AVAILABLE FOR LEASE

JOIN:



**LEE & ASSOCIATES**  
COMMERCIAL REAL ESTATE SERVICES  
Corporate DRE#: 01048055  
www.lee-associates.com

**NICK WIRICK | 951.276.3636 | DRE#: 01304661 | NWIRICK@LEERIVERSIDE.COM**

**CHRIS BEAUCHAMP | 951.276.3675 | DRE#: 01982753 | CBEAUCHAMP@LEERIVERSIDE.COM**

*No warranty or representation has been made to the accuracy of the foregoing information. Terms of sale or lease and availability are subject to change or withdrawal without notice. Lee & Associates Commercial Real Estate Services, Inc. - Riverside.*





# DESERT HILLS PLAZA

57252 Twentynine Palms Highway, Yucca Valley, CA 92284

## PROPERTY FEATURES

±12,572 SF of Junior Anchor space available.

Center of town location, servicing Yucca Valley, Joshua Tree, 29 Palms, Landers and Lucerne Valley.

Situated at the hard-corner signalized intersection of 29 Palms HWY and Old Woman Springs, which services over 42,000 cars per day.

Pylon signage available.

Great opportunity for soft goods, fitness, furniture and retail stores.

## TRADE AREA DEMOGRAPHICS



Population: 77,548 Residents



Average HH Income: \$55,836.00



Median Age: 37 Years



Labor Force: 15,155



Median Home Values: \$226,000.00

## JOIN AREA TENANTS:

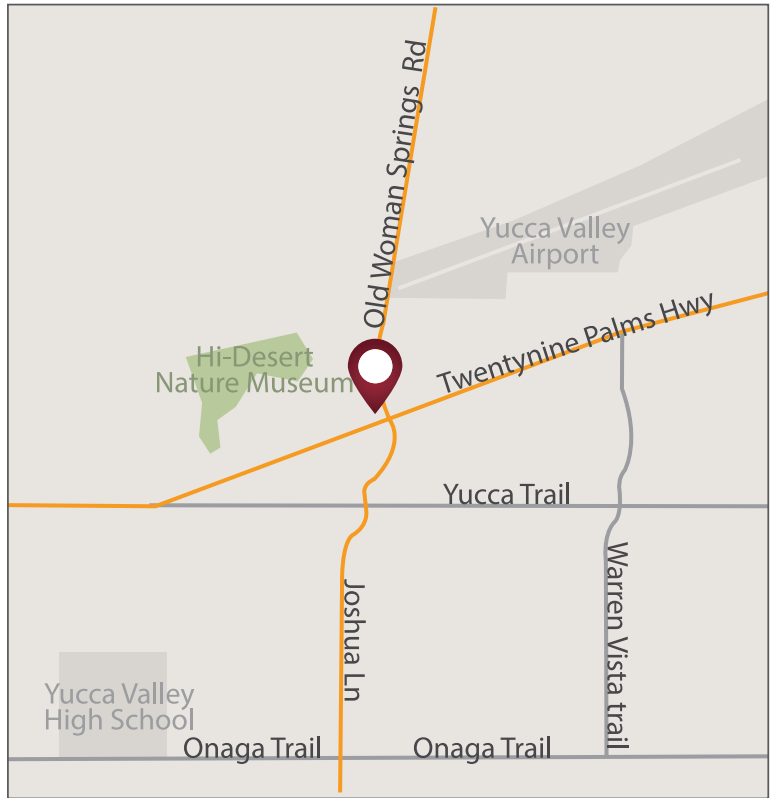

**LEE & ASSOCIATES**  
COMMERCIAL REAL ESTATE SERVICES  
Corporate DRE#: 01048055  
www.lee-associates.com

**NICK WIRICK | 951.276.3636 | DRE#: 01304661 | NWIRICK@LEERIVERSIDE.COM**

**CHRIS BEAUCHAMP | 951.276.3675 | DRE#: 01982753 | CBEAUCHAMP@LEERIVERSIDE.COM**

*No warranty or representation has been made to the accuracy of the foregoing information. Terms of sale or lease and availability are subject to change or withdrawal without notice. Lee & Associates Commercial Real Estate Services, Inc. - Riverside.*



# DESERT HILLS PLAZA

57252 Twentynine Palms Highway, Yucca Valley, CA 92284

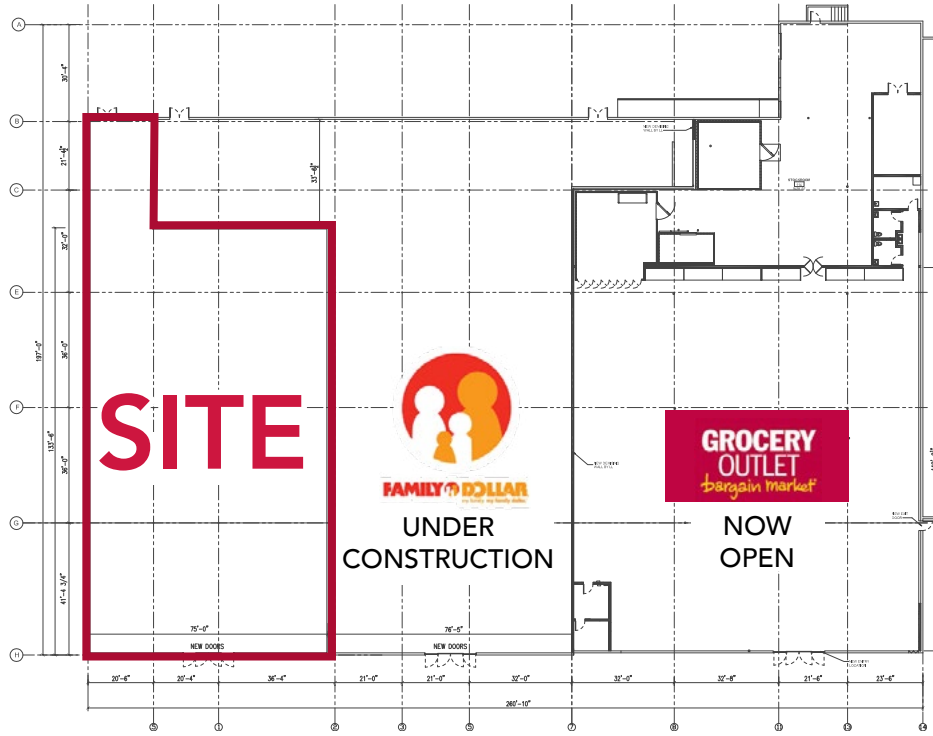

**LEE & ASSOCIATES**  
 COMMERCIAL REAL ESTATE SERVICES  
 Corporate DRE#: 01048055  
 www.lee-associates.com

**NICK WIRICK | 951.276.3636 | DRE#: 01304661 | NWIRICK@LEERIVERSIDE.COM**

**CHRIS BEAUCHAMP | 951.276.3675 | DRE#: 01982753 | CBEAUCHAMP@LEERIVERSIDE.COM**

*No warranty or representation has been made to the accuracy of the foregoing information. Terms of sale or lease and availability are subject to change or withdrawal without notice. Lee & Associates Commercial Real Estate Services, Inc. - Riverside.*