

# FOR LEASE | ± 1,500 - 6,038 SF

## High-Image Multi-Tenant Buildings

8200-8220 Katella Avenue, Stanton, CA



### PROPERTY FEATURES

- High Image Multi-Tenant Buildings
- Mix of Industrial, Office, and Retail Units
- On-Site Property Management & Security
- Spectrum High Speed Internet
- Excellent Access to the 22 & Beach Blvd.
- High Identity Location in Excellent Stanton Area (Beach Blvd., Katella Ave., are closest cross streets)
- Retail and Industrial Units Have Ground Level Roll-Up Doors & Private Restrooms
- BP Zoning (*Verify*)

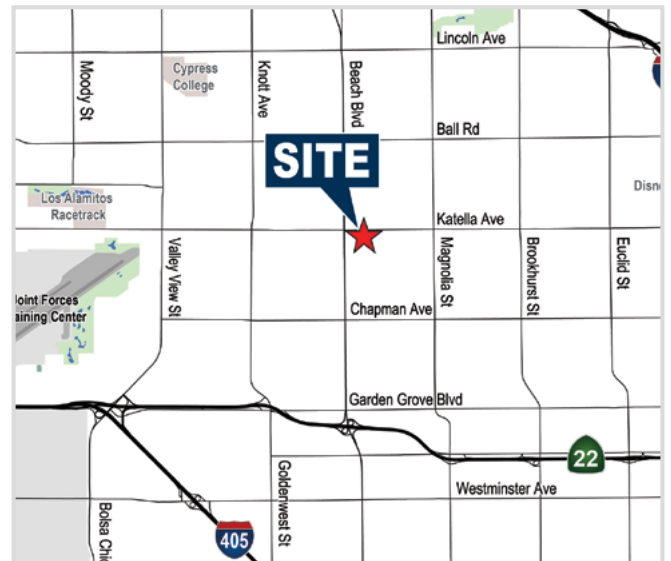

**ERIC SMITH, SIOR**  
Senior Vice President  
714.935.2310  
esmith@voitco.com  
Lic. #01940591  
www.ericrandolphsmith.com



**DYLAN SHERSHENOVICH**  
Associate  
714.935.2312  
dshershenovich@voitco.com  
Lic. #02151453

**Voit**  
REAL ESTATE SERVICES

**FOR LEASE | ± 1,500 - 6,038 SF**

**High-Image Multi-Tenant Buildings**

**8200-8220 Katella Avenue, Stanton, CA**



**ERIC SMITH, SIOR**  
 Senior Vice President  
 714.935.2310  
 esmith@voitco.com  
 Lic. #01940591  
 www.ericandolphsmith.com



**DYLAN SHERSHENOVICH**  
 Associate  
 714.935.2312  
 dshershenovich@voitco.com  
 Lic. #02151453

**Voit**  
 REAL ESTATE SERVICES

# FOR LEASE | ± 1,500 - 6,038 SF

## High-Image Multi-Tenant Buildings

8200-8220 Katella Avenue, Stanton, CA

Suite G



### INDUSTRIAL: 8210 KATELLA AVENUE

Suite	Size SF	Office SF	Asking Rate/SF	Availability	Comments
G	± 1,500	± 300	\$1.65 PSF	Now	Newly Rehabbed, 2 Private Offices, 1 Private Restroom, 17' ft. Clear Door, HVAC in Office, New Skylights, 1 GL Door



**ERIC SMITH, SIOR**  
 Senior Vice President  
 714.935.2310  
 esmith@voitco.com  
 Lic. #01940591  
 www.ericandolphsmith.com



**DYLAN SHERSHENOVICH**  
 Associate  
 714.935.2312  
 dshershenovich@voitco.com  
 Lic. #02151453



# FOR LEASE | ± 1,500 - 6,038 SF

## High-Image Multi-Tenant Buildings

8200-8220 Katella Avenue, Stanton, CA

### Suite H



#### INDUSTRIAL: 8210 KATELLA AVENUE

Suite	Size SF	Office SF	Asking Rate/SF	Availability	Comments
H	± 1,500	± 300	\$1.65 PSF	Now	Newly Rehabbed, 2 Private Offices, 1 Private Restroom, 17' ft. Clear Door, HVAC in Office, New Skylights, 1 GL Door



**ERIC SMITH, SIOR**  
Senior Vice President  
714.935.2310  
esmith@voitco.com  
Lic. #01940591  
www.ericandolphsmith.com



**DYLAN SHERSHENOVICH**  
Associate  
714.935.2312  
dshershenovich@voitco.com  
Lic. #02151453

**Voit**  
REAL ESTATE SERVICES

**FOR LEASE | ± 1,500 - 6,038 SF**

**High-Image Multi-Tenant Buildings**

**8200-8220 Katella Avenue, Stanton, CA**

Suite I-J

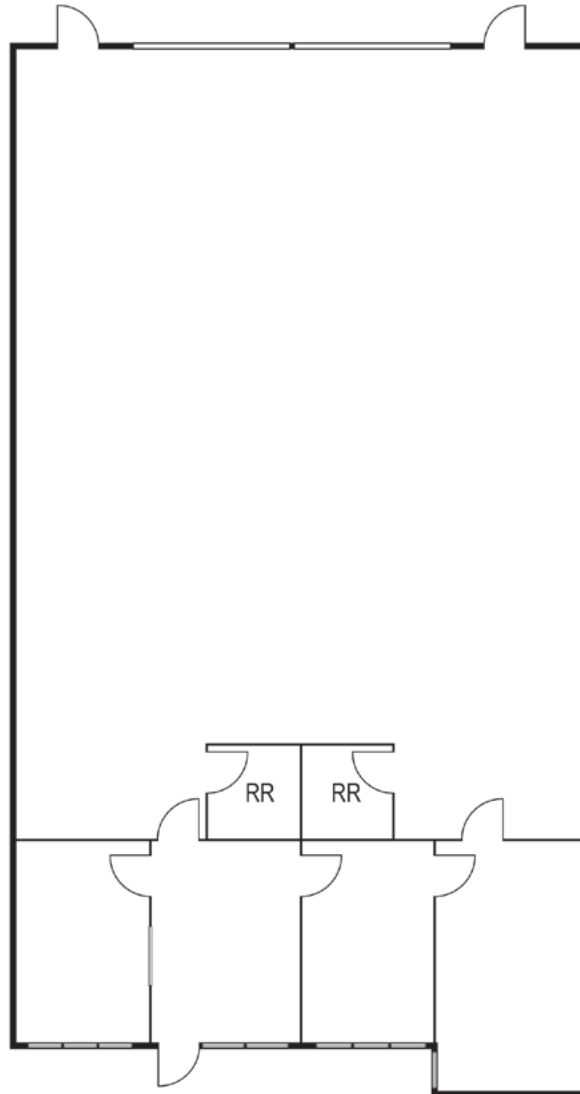

**INDUSTRIAL: 8210 KATELLA AVENUE**

Suite	Size SF	Office SF	Asking Rate/ SF	Availability	Comments
I-J	± 3,038	± 590	\$1.65 PSF	Now	Newly Rehabbed, 4 Private Offices, 2 Private Restrooms, 17' ft. Clear Door, HVAC in Office, New Skylights, 2 GL Doors



**ERIC SMITH, SIOR**  
Senior Vice President  
714.935.2310  
esmith@voitco.com  
Lic. #01940591  
www.ericrandolphsmith.com



**DYLAN SHERSHENOVICH**  
Associate  
714.935.2312  
dshershenovich@voitco.com  
Lic. #02151453

**Voit**  
REAL ESTATE SERVICES

# FOR LEASE | ± 1,500 - 6,038 SF

## High-Image Multi-Tenant Buildings

8200-8220 Katella Avenue, Stanton, CA

### Suite G-J

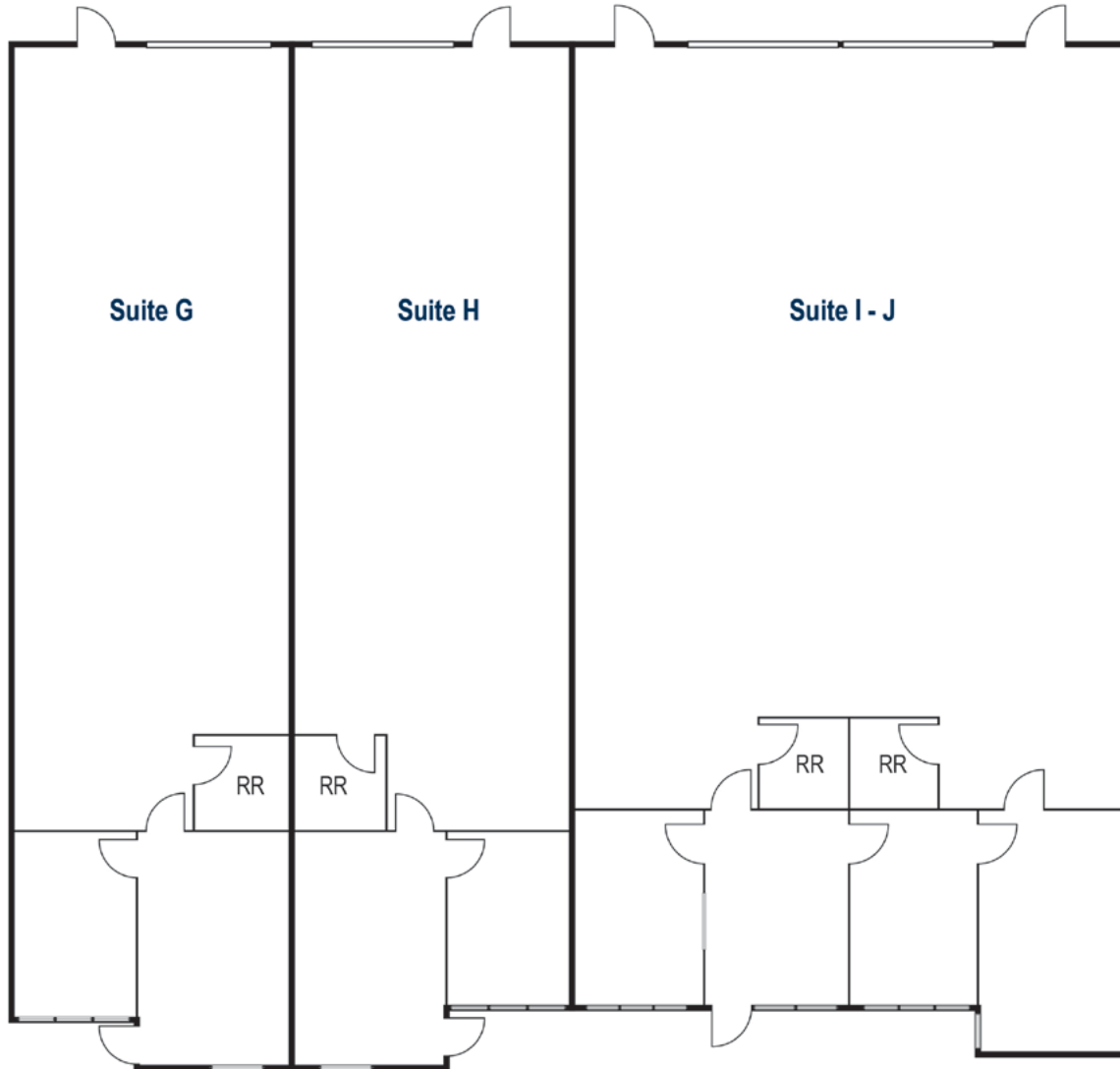

#### INDUSTRIAL: 8210 KATELLA AVENUE

Suite	Size SF	Office SF	Asking Rate/ SF	Availability	Comments
G-J	± 6,038	± 1,190	\$1.65 PSF	Now	Newly Rehabbed, 8 Private Offices, 4 Private Restrooms, 17' ft. Clear Door, HVAC in Office, New Skylights, 4 GL Doors



**ERIC SMITH, SIOR**  
 Senior Vice President  
 714.935.2310  
 esmith@voitco.com  
 Lic. #01940591  
 www.ericandolphsmith.com



**DYLAN SHERSHENOVICH**  
 Associate  
 714.935.2312  
 dshershenovich@voitco.com  
 Lic. #02151453

