

FOR LEASE > HIGH IMAGE OFFICE/WAREHOUSE SPACE

# Waterworks Business Park

30 WATERWORKS WAY, IRVINE, CA

Colliers



MICHAEL HARTEL  
LICENSE NO. 01031013  
949 724 5700  
michael.hartel@colliers.com

NICK VELASQUEZ  
LICENSE NO. 01946515  
949 724 5707  
nick.velasquez@colliers.com

COLLIERS INTERNATIONAL  
3 Park Plaza, Suite 1200  
Irvine, CA 92614  
www.colliers.com

# SITE PLAN



Building #	Total Square Feet	1st Floor Office (Approx.)	2nd Floor Mezzanine (Approx.)	Warehouse	Lease Rate Month/NNN	Availability
30	3,363	1,302	963	1,098	\$2.00	AVAILABLE
32	3,704	1,318	983	1,403	N/A	LEASED
34	3,923	1,307	971	1,645	N/A	LEASED
36	3,923	1,307	971	1,645	N/A	LEASED
38	3,707	1,302	963	1,442	N/A	LEASED
40	3,707	1,302	963	1,442	N/A	LEASED
42	3,923	1,307	971	1,645	N/A	LEASED
44	3,923	1,307	971	1,645	N/A	LEASED
46	3,704	1,318	983	1,403	N/A	LEASED
48	3,363	1,302	963	1,098	\$1.95	LEASED

\*Estimated operating expenses are \$0.51 PSF/month.

## 30 - WATERWORKS WAY

- First Floor Office: ± 1,302 SF
- Second Floor Office: ± 963 SF
- Warehouse Area: ± 1,098 SF
- Total Area: ± 3,363 SF
- Private Offices
- Coffee Bar / Break Area
- Restrooms
- Ground Level Loading (12' W x 14' H)
- Approximately 3:1 Parking Ratio
- Approximately 22' Warehouse Clearance
- 200 Amps, 208/120 Power (3 Phase, 4 Wire)
- High Image Business Park
- End Unit

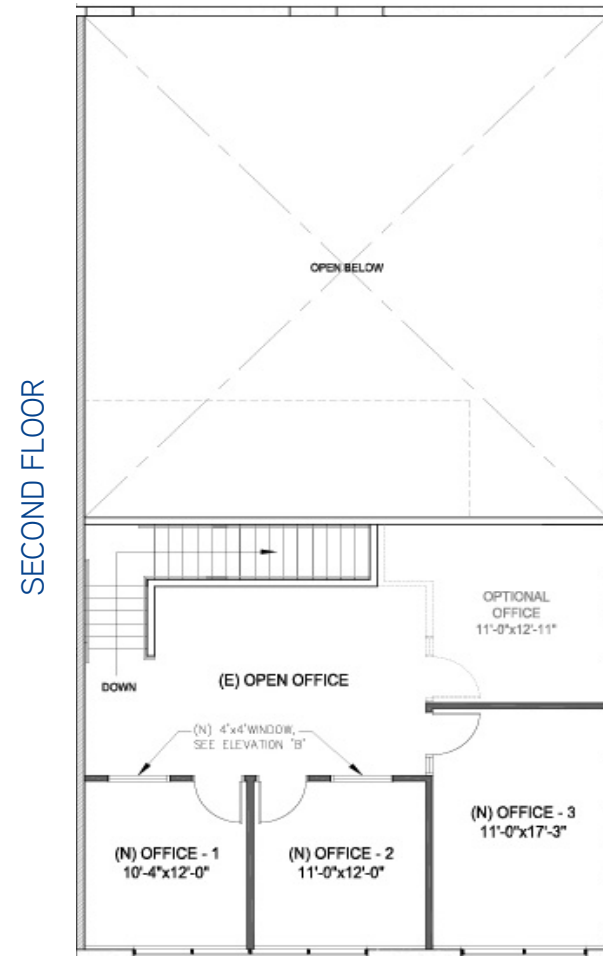
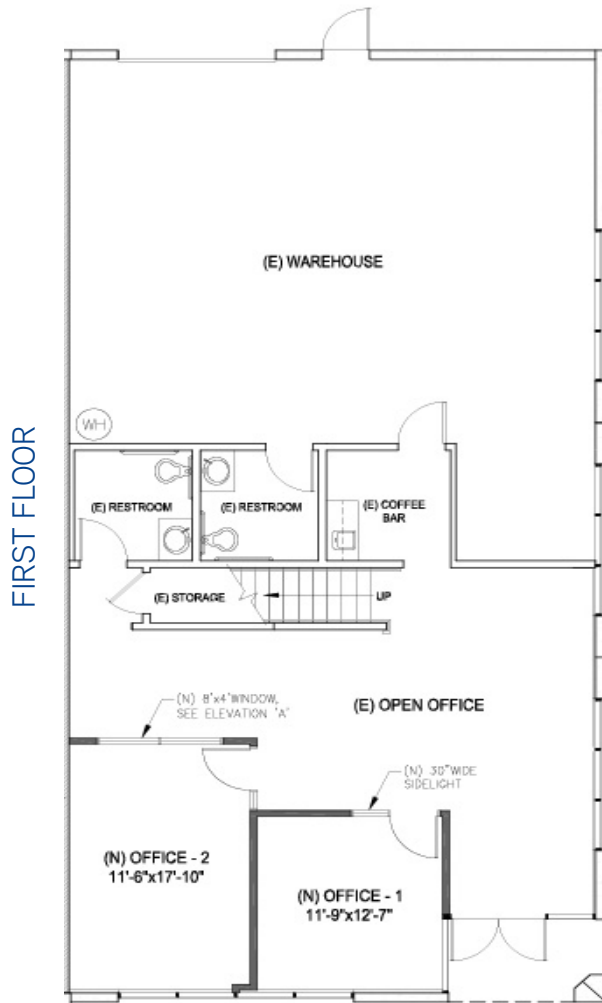

# PROPERTY FEATURES

- ±50% Improved Office Area, Restrooms Included
- Close Proximity to Irvine Regional Hospital and Kaiser Permanente
- One Block to Retail Amenities
- Fully Sprinklered
- Close to the 5, 405 & 133 Freeways
- Close to the Irvine Spectrum Entertainment Center



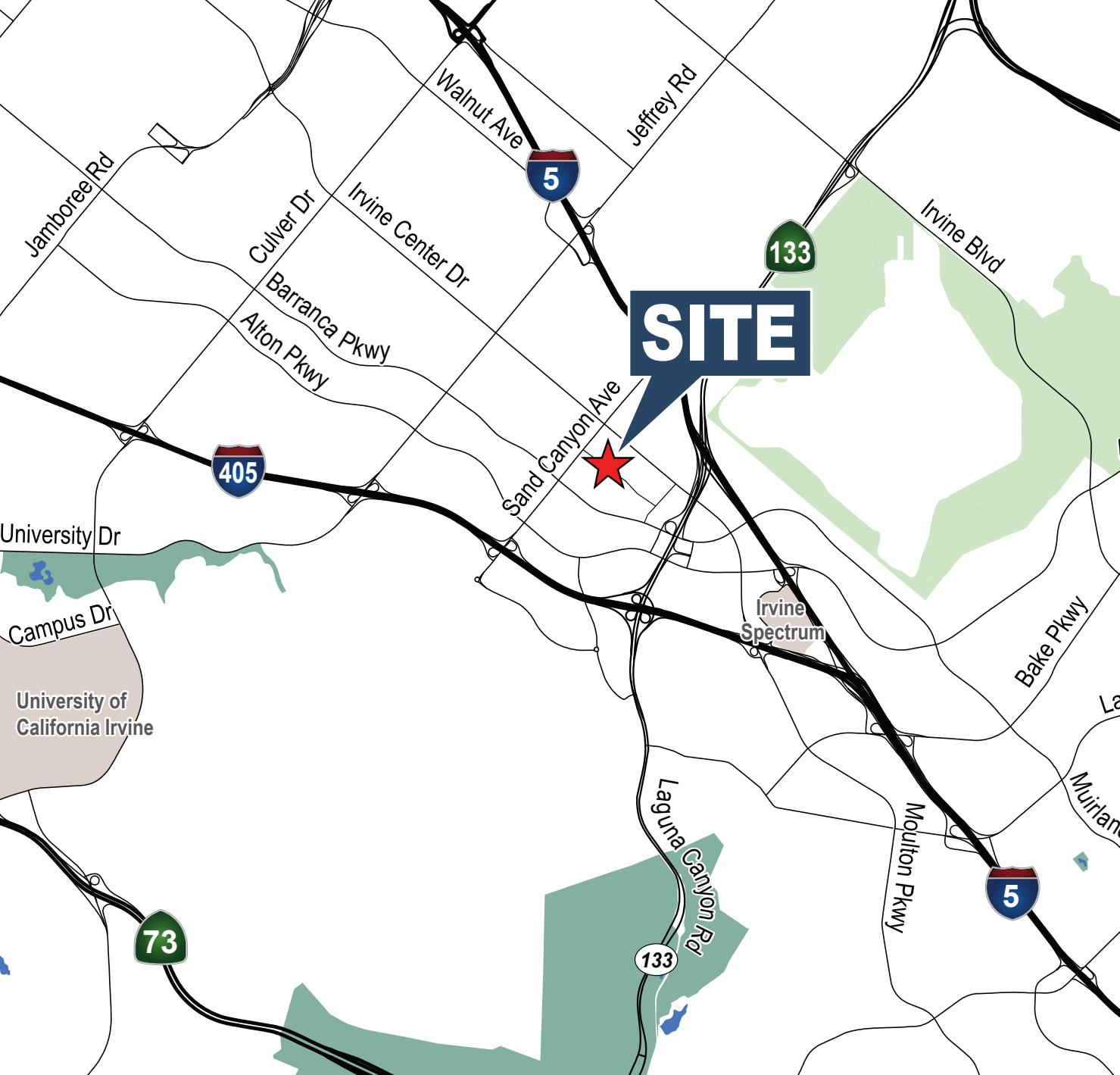

## Waterworks Business Park >

30 Waterworks Way  
Irvine, CA

### Contact Us

---

MICHAEL HARTEL

LICENSE NO. 01031013

949 724 5700

IRVINE, CA

[michael.hartel@colliers.com](mailto:michael.hartel@colliers.com)

NICK VELASQUEZ

LICENSE NO. 01946515

949 724 5707

IRVINE, CA

[nick.velasquez@colliers.com](mailto:nick.velasquez@colliers.com)

---

COLLIERS INTERNATIONAL

3 Park Plaza, Suite 1200

Irvine, CA 92614

[www.colliers.com](http://www.colliers.com)