

AVAILABILITY

2100 - 2110 E. McFadden Ave.
Santa Ana, CA 92705

Voit

REAL ESTATE SERVICES

Address	Suite	Total Size ¹	Asking Rate Mod. Gross Per Sq. Ft.	Monthly Rent	Comments
2100 E. McFadden Ave.	E	±1,248	\$1.45 PSF Mod. Gross	\$1,810.00	Office, restroom and warehouse with ground level loading door. Desirable end unit.

**There is an additional Common Area Maintenance (CAM) Fee of \$75.00 per month.*

¹Approximate total and office square footage

Hayden Socci, CCIM
Senior Vice President | Partner
714.935.2379
hsocci@voitco.com
Lic #0175038

2400 E. Katella Avenue. Ste. 750. Anaheim. CA 92806 • 714.978.7880 • 714.276.0664 Fax • Lic #01991785 | www.voitco.com

The information contained herein has been obtained from sources we deem reliable. While we have no reason to doubt its accuracy, we do not guarantee it. ©2023 Voit Real Estate Services, Inc. All Rights Reserved. Real People. Real Solutions.® is a registered trademark of Voit Real Estate Services.

AVAILABILITY

2100 - 2110 E. McFadden Ave.
Santa Ana, CA 92705

Voit

REAL ESTATE SERVICES



Property Highlights:

- **Business Park Environment**
- **Units Range From 1,248 to 5,720 Sq. Ft.**
- **McFadden Avenue Street Frontage**
- **Multiple Sizes & Configurations**
- **Ground Level Loading Door(s)**
- **±14' Warehouse Clearance**
- **Designated Parking**
- **Excellent Access to the 55, 5 and 405 Freeways**

Hayden Socci, CCIM
Senior Vice President | Partner
714.935.2379
hsocci@voitco.com
Lic #01705038

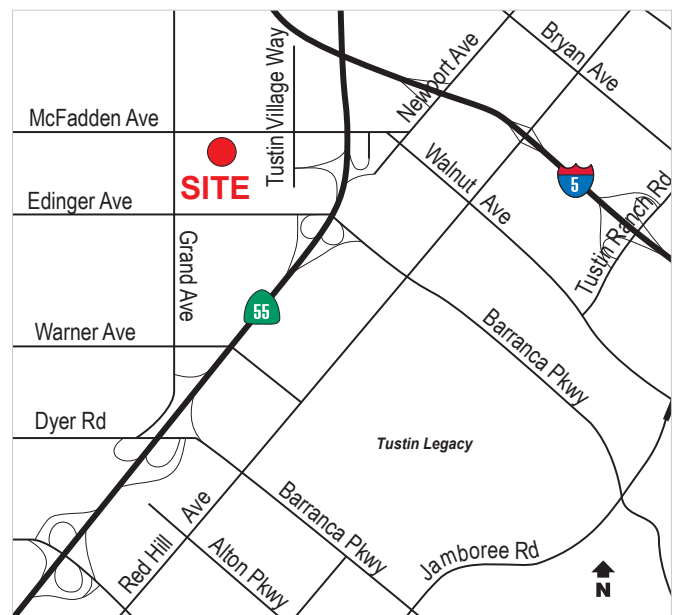

AVAILABILITY

2100 - 2110 E. McFadden Ave.
Santa Ana, CA 92705

McFADDEN AVE

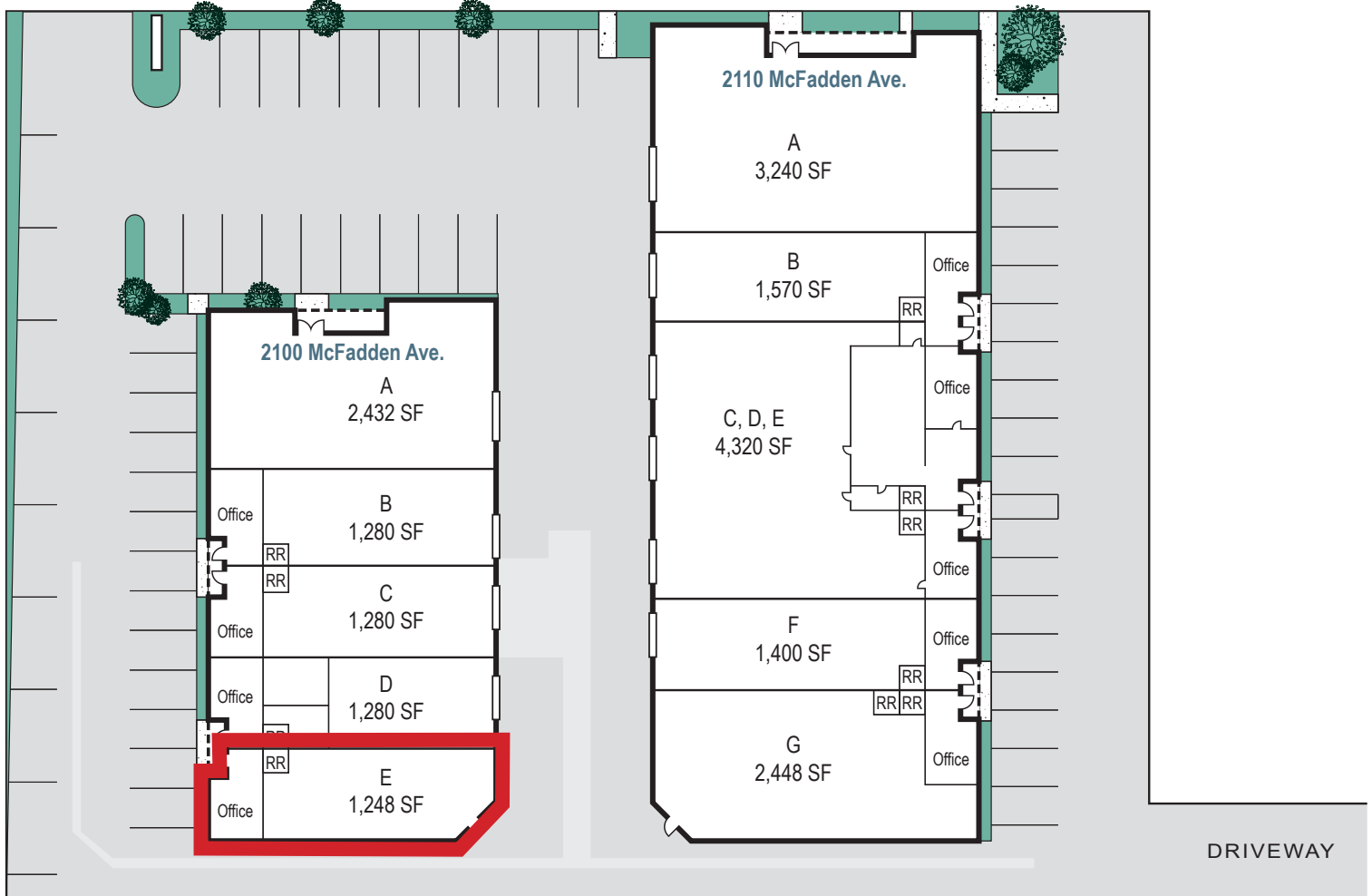

Hayden Socci, CCIM
Senior Vice President | Partner
714.935.2379
hsocci@voitco.com
Lic #01705038

Voit
REAL ESTATE SERVICES

2400 E. Katella Ave., Ste. 750, Anaheim, CA 92806 • 714.978.7880 • 714.276.0664 Fax • Lic #01991785 | www.voitco.com

The information contained herein has been obtained from sources we deem reliable. While we have no reason to doubt its accuracy, we do not guarantee it. ©2023 Voit Real Estate Services, Inc. All Rights Reserved. Real People. Real Solutions.™ is a trademark of Voit Real Estate Services.

AVAILABILITY

2100 - 2110 E. McFadden Ave.
Santa Ana, CA 92705

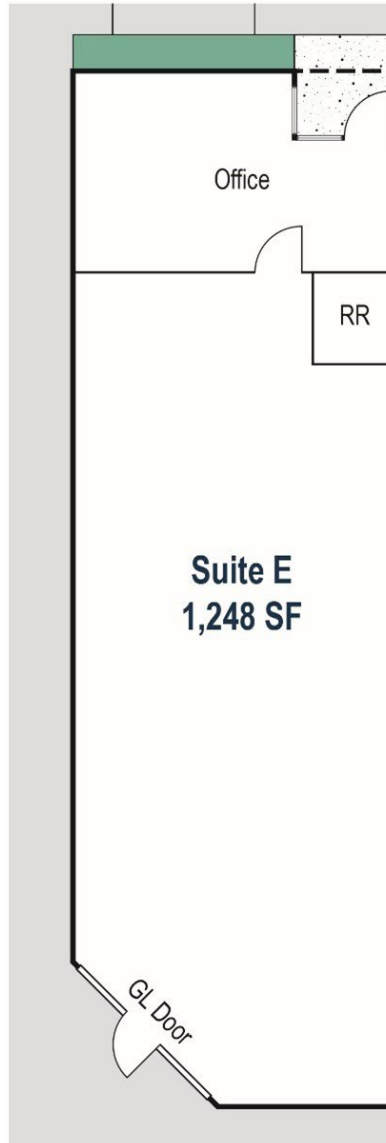

2100 E. McFadden Ave.
Suite E
±1,248 Sq. Ft.

Hayden Socci, CCIM
Senior Vice President | Partner
714.935.2379
hsocci@voitco.com
Lic #01705038

Voit
REAL ESTATE SERVICES

2400 E. Katella Ave., Ste. 750, Anaheim, CA 92806 • 714.978.7880 • 714.276.0664 Fax • Lic #01991785 | www.voitco.com

The information contained herein has been obtained from sources we deem reliable. While we have no reason to doubt its accuracy, we do not guarantee it. ©2023 Voit Real Estate Services, Inc. All Rights Reserved. Real People. Real Solutions.™ is a trademark of Voit Real Estate Services.