



MURRIETA  
**TOWN  
CENTER**

NEQ I-215 FWY &  
MURRIETA HOT SPRINGS RD  
MURRIETA, CA

The Murrieta Town Center is  
a ±380,315 Square Foot  
Community Shopping Center  
Strategically Positioned Within  
The “Golden Triangle” Area.

### CENTER FEATURES:

- Amazon Fresh, Floor & Décor, Salon Republic Now Open!
- Located at the Gateway to Murrieta & The Temecula Valley
- Major Renovation Underway
- Jr Anchor Build to Suit Opportunities Up to 10,000 SF
- Shop Space Opportunities From 1,275 SF
- Restaurant Opportunities – Contact Broker For Details
- Approximately 2,000 Lineal Feet Unparallel Interstate 215 Frontage
- Prominent Monument Signage Available Along Murrieta Hot Springs Road
- Excellent 215 Freeway Access & A Short Distance To/From Interstate 15

**BRIAN BIELATOWICZ**

951.445.4515

[bbielatowicz@leetemecula.com](mailto:bbielatowicz@leetemecula.com)

DRE #01269887

**TED RIVENBARK**

951.445.4512

[trivenbark@leetemecula.com](mailto:trivenbark@leetemecula.com)

DRE #01247098

 **LEE &  
ASSOCIATES**  
COMMERCIAL REAL ESTATE SERVICES

No warranty or representation has been made to the accuracy of the foregoing information. Terms of sale or lease and availability are subject to change or withdrawal without notice. Lee & Associates Commercial Real Estate Services, Inc. - Riverside. 25240 Hancock Avenue, Suite 100 - Murrieta, CA 92562 | Corporate ID# 01048055

## MEET YOUR CO-TENANTS







**OVER 32,500  
HOMES AND 113,000  
RESIDENTS WITHIN A  
3-MILE RADIUS OF THE  
PROPERTY**

SILVERADO  
LUXURY  
APARTMENTS  
(492 UNITS)

UNIVERSITY  
OF PHOENIX

RANCHO  
LAS BRISAS  
APARTMENTS  
(200 UNITS)

SIERRA VISTA PLAZA  
CVS/pharmacy  
CHUCK E. CHEESE'S  
Pizza Hut

CROSSROADS  
CORPORATE CENTER  
(157,000+ SF)

Rady  
Children's

Hampton  
Inn

RANCHO SPRINGS  
MEDICAL CENTER  
(252-BED REGIONAL  
HOSPITAL)

HOWARDS  
NOW OPEN

FLOOR  
DECOR  
NOW OPEN

2,000 FEET  
OF FREEWAY  
FRONTAGE

I-215 (91,000 VPD)

INTERSTATE  
215

ROSS  
DRESS FOR LESS

Burlington

DOLLAR TREE

Marshalls

FIVE BELOW

FAMOUS  
footwear

amazon  
fresh  
NOW OPEN

DIRECT  
FREEWAY  
ACCESS - ON/  
OFF RAMP

Sizzler

STARBUCKS  
COFFEE



DIRECT OFF  
RAMP

MURRIETA HOTSPRINGS ROAD (74,800 CPD)

eye  
SUSHI & GRILL



Prominent Monument  
Signage Available Along  
Murrieta Hot Springs Road

Sam's  
CLUB  
BUFFALO WILD WINGS  
GOLF & BAR  
Walgreens





NEQ I-215 FWY &  
MURRIETA HOT SPRINGS RD  
MURRIETA, CA

# SITE PLAN



**BUILD TO SUIT**  
Up to ±9,070 SF  
Future Building

**FROM 1,275 - 14,362 SF AVAILABLE**  
2-B03 6,942 SF - Available w/30 Days' Notice  
2-B04 1,520 SF - Available w/30 Days' Notice  
2-B05 5,900 SF - Available w/30 Days' Notice  
2-B16 1,700 SF

**UP TO 3,200 SF AVAILABLE**  
2-D02 3,200 SF

**BUILD TO SUIT**  
±3,500 - 10,000 SF  
Divisible

**UP TO ±5,145 SF DIVISIBLE INTO 3 UNITS FROM ±1,708 SF**  
1-D08 2,421 SF  
1-D10 2,724 SF



**LEGEND**

- AVAILABLE
- POTENTIALLY AVAILABLE
- OCCUPIED
- LEASE PENDING



# CONCEPTUAL DEMISING PLAN UNITS 1-D08 & 1-D10 UP TO ±5,145 SF DIVISIBLE INTO 3 UNITS FROM ±1,708 SF

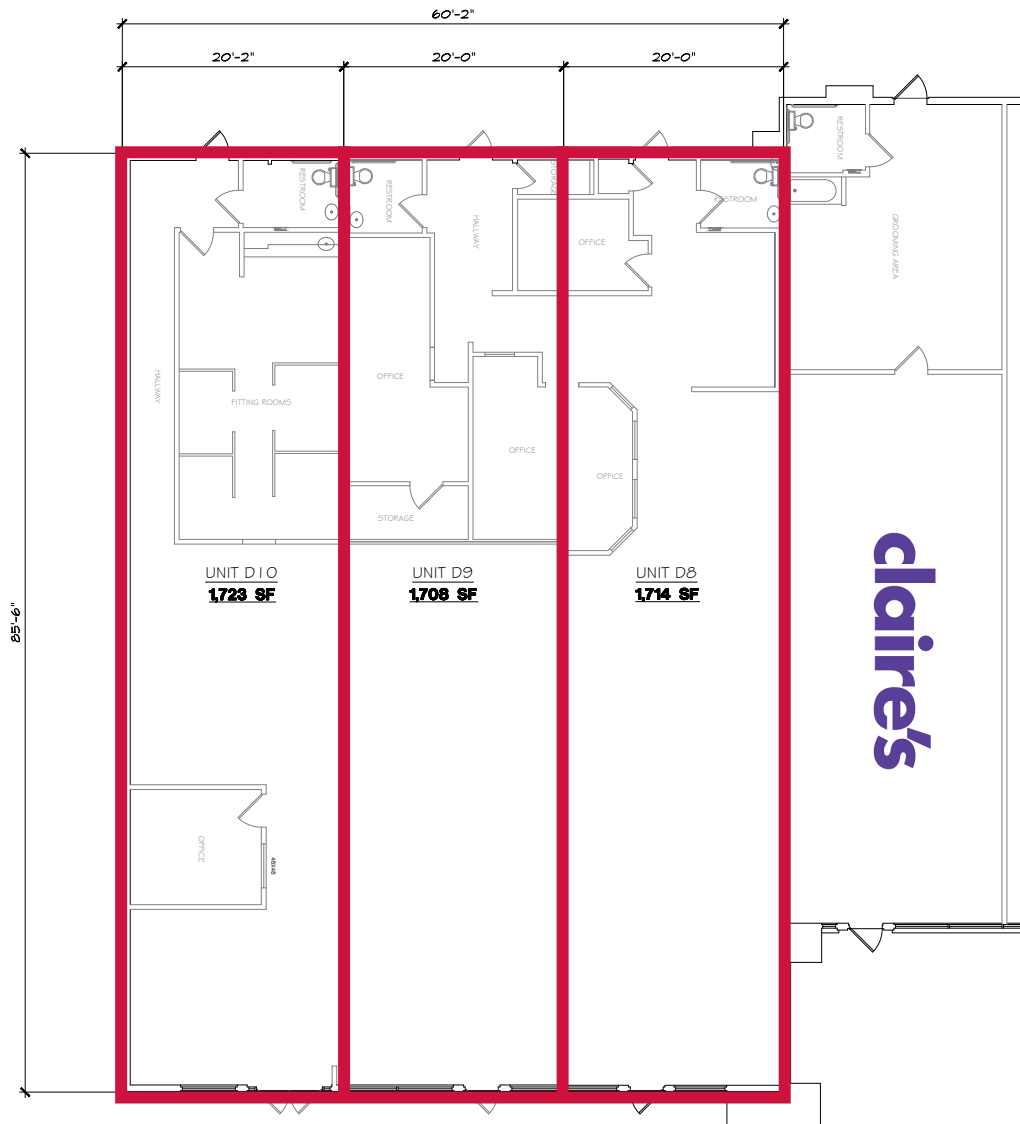



BUILD TO SUIT UP TO ±9,070 SF

NOW OPEN

NOW OPEN

AVAILABLE

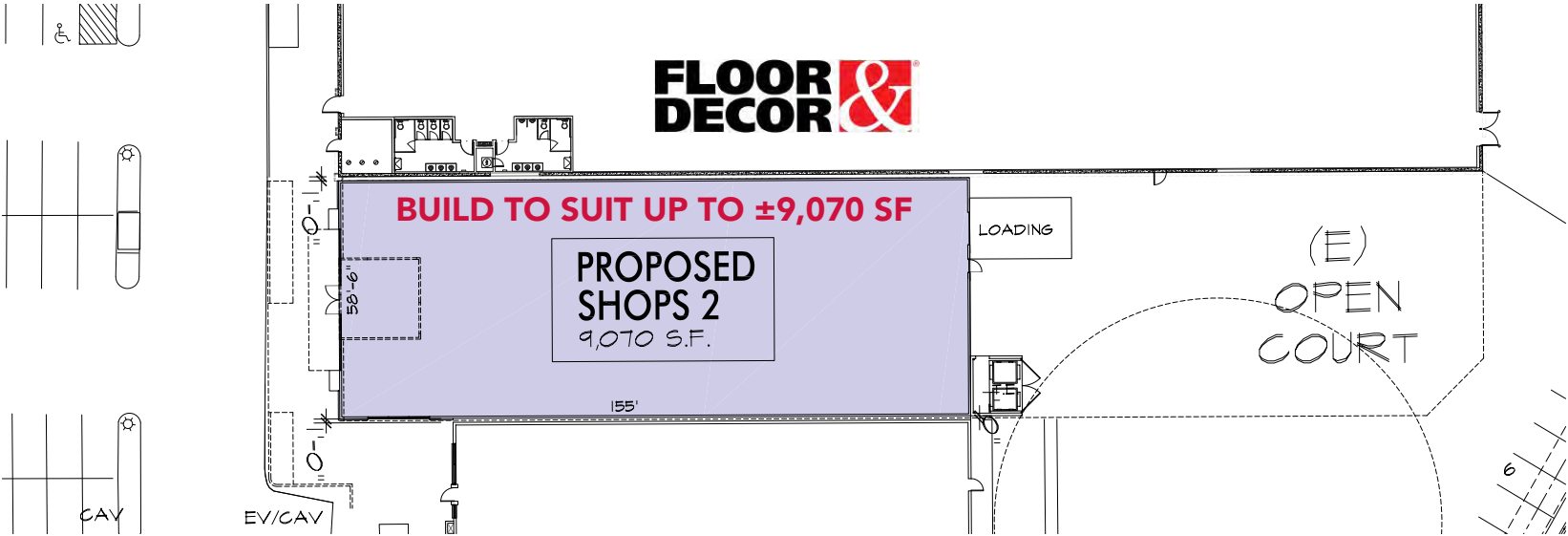



# BUILD TO SUIT ±3,500 - ±10,000 SF

**AVAILABLE**

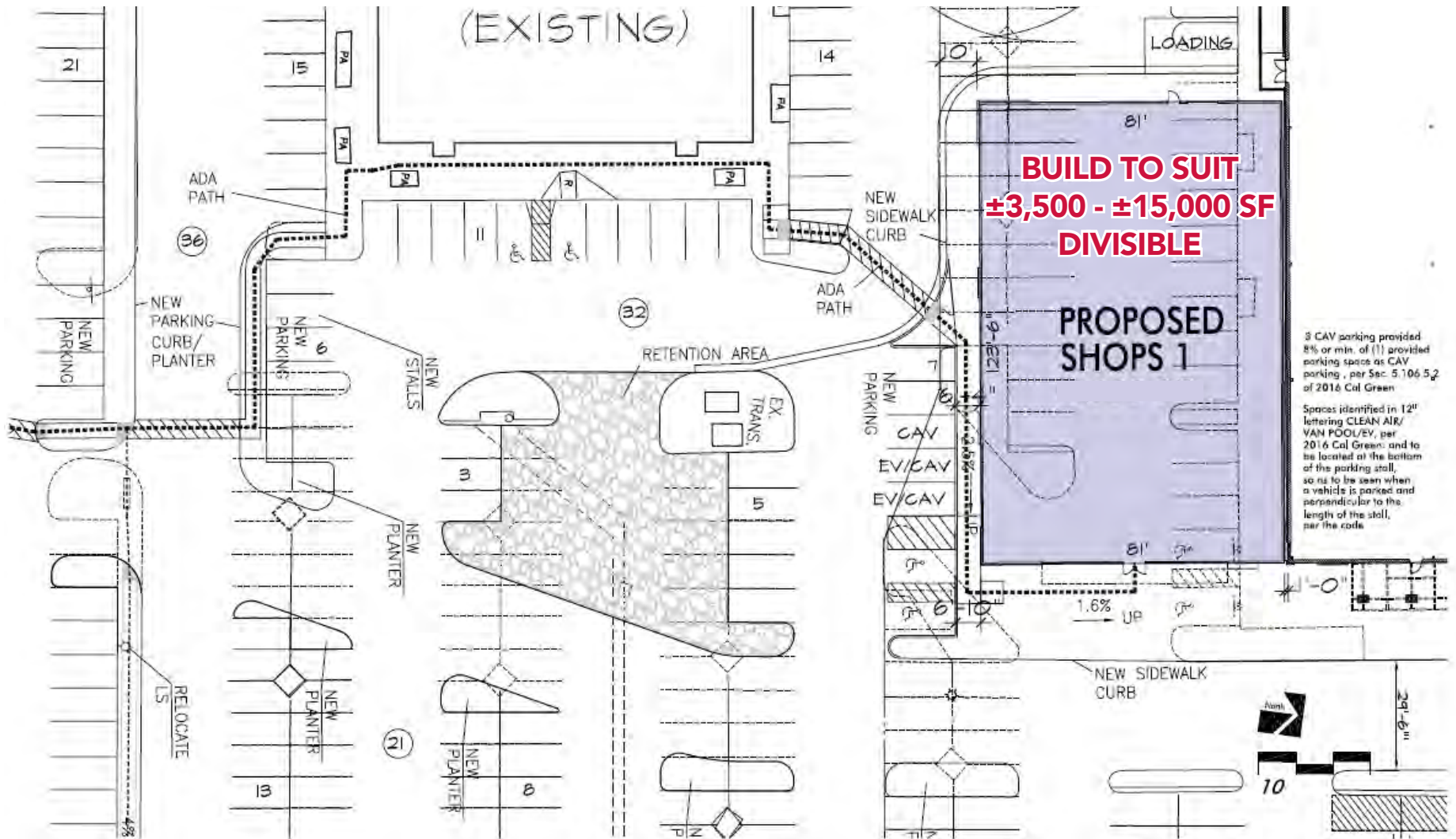



# REMODEL UNDERWAY





# MURRIETA TOWN CENTER



POPULATION:  
7,832

HUNTER RD

POPULATION:  
2,104

POPULATION:  
4,302

CORNERSTONE COMMUNITIES  
253 SF  
HOMES UNDER  
CONSTRUCTION

MURRIETA HOTSPRINGS RD: 57,100 CPD

1,527  
UNITS

POPULATION:  
2,278

2,842  
UNITS

POPULATION:  
7,320

909  
UNITS

POPULATION:  
3,447

2,289  
UNITS

POPULATION:  
7,046

JEFFERSON AVE

FUTURE  
FRENCH VALLEY  
PKWY OFFRAMP

3,240  
UNITS

POPULATION:  
4,965

DATE ST EXTENSION TIMED WITH PROJECT

WINCHESTER RD NB: 36,000 CPD



STAN  
PA  
198 SF





## DEMOGRAPHICS

*3-mile radius*

Population	103,563	Median Household Income	\$91,407
Average Household Income	\$105,530	Daytime Population	73,784
Households	33,982	Median Age	36.6

## TRAFFIC COUNTS

**74,800 CPD**  
Murrieta Hot Springs Road



**92,489 CPD**  
I-215 Freeway





MURRIETA

# TOWN CENTER

NEQ I-215 FWY &  
MURRIETA HOT SPRINGS RD  
MURRIETA, CA

**BRIAN BIELATOWICZ**

951.445.4515

[bbielatowicz@leetemecula.com](mailto:bbielatowicz@leetemecula.com)

DRE #01269887

**TED RIVENBARK**

951.445.4512

[trivenbark@leetemecula.com](mailto:trivenbark@leetemecula.com)

DRE #01247098

 **LEE &  
ASSOCIATES**  
COMMERCIAL REAL ESTATE SERVICES