

# LINCOLN PLAZA

3050 W. Lincoln Avenue, Suite D Anaheim 92801

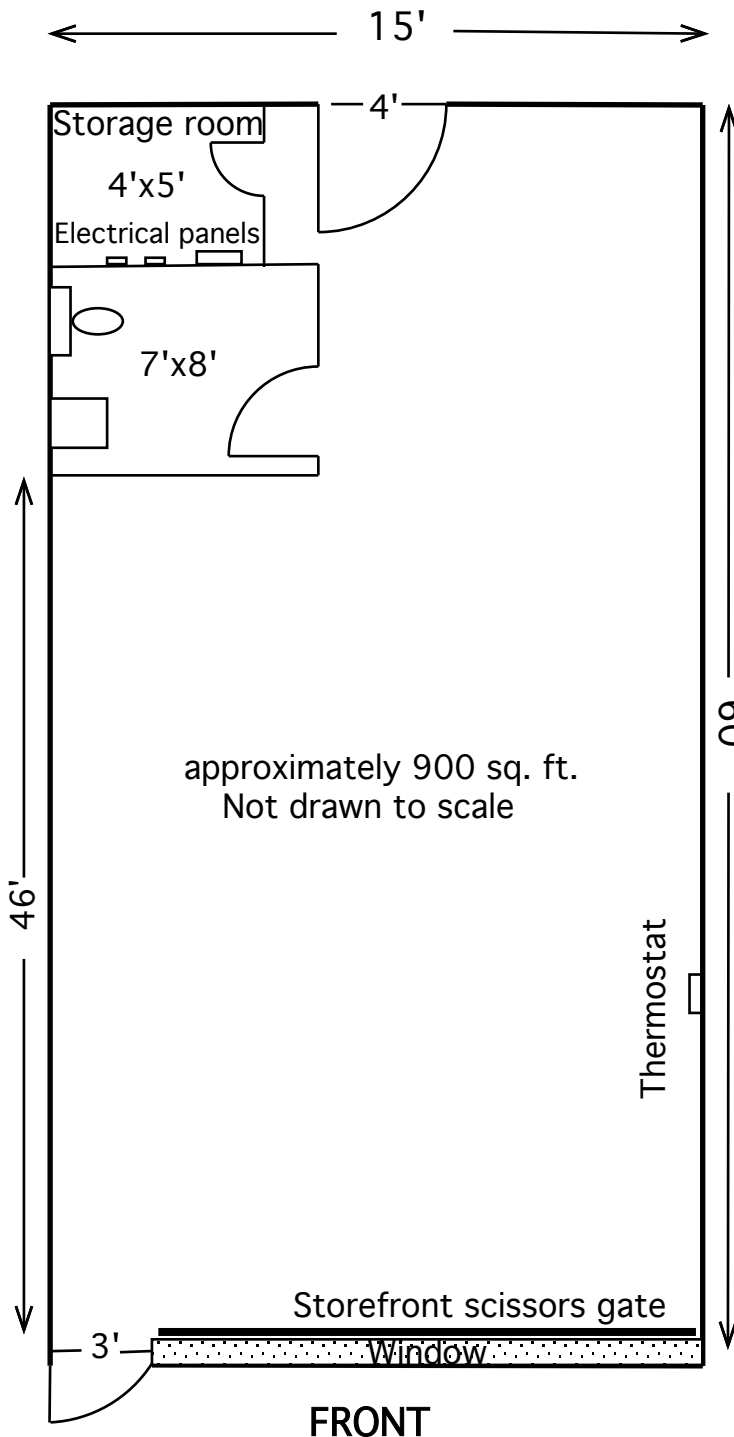

## FEATURES:

- Frontage retail unit on Lincoln Ave.
- Ceiling height approximately 10ft
- Large directory sign available
- Rear gate access
- New central HVAC/LED light panels
- Approximately 27,000 traffic count per day, since 2007

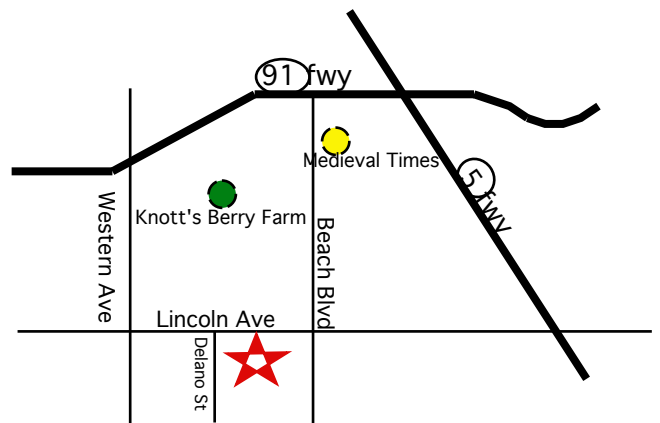

SCAN BELOW  
FOR UP-TO-DATE  
INFO ON WEBSITE



[www.SDAssociatesProperties.com](http://www.SDAssociatesProperties.com)

updated 8-21-18

**CONTACT Property Manager, Salila Limolansuksakul, at (714)997-7956 ext 102**

S&D ASSOCIATES LEASING OFFICE: 1020 N. BATAVIA ST. STE. B, ORANGE, CA 92867  
TEL 714/997-7956 \* FAX 714/997-4930 \* [Leasing@SDAssociatesProperties.com](mailto:Leasing@SDAssociatesProperties.com)