

WHITE STAR BUSINESS PARK

2821 E. White Star Avenue, Unit J

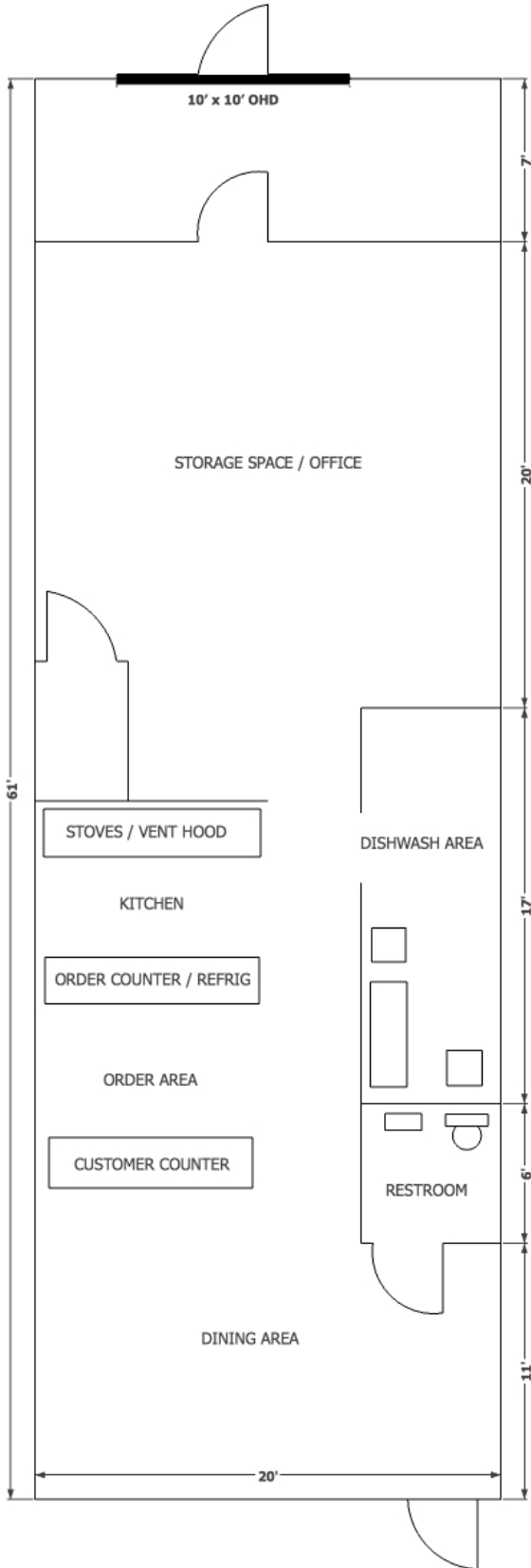

Features:

- Approximately 1,220 SF
- 100 amps
- Restaurant 'ready' / includes commercial appliances
- Kitchen, dishwash room, and restroom
- Large storage space/office area
- Close to 57/91/55 freeways

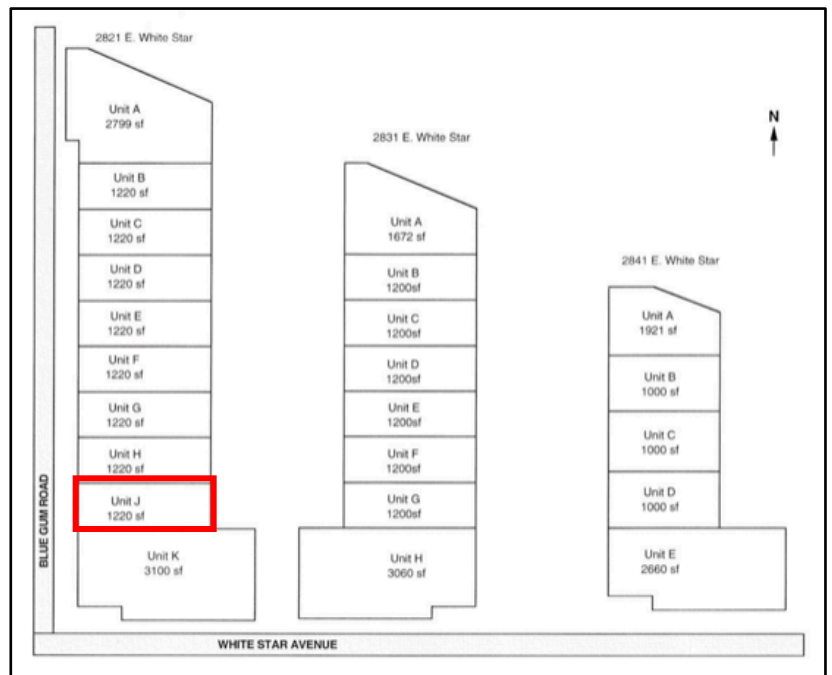

SCAN BELOW
FOR UP TO DATE
INFO ON WEBSITE



S&D ASSOCIATES LEASING OFFICE: 1020 N. BATAVIA ST. STE B, ORANGE, CA 92867
TEL: 714-997-7956 * FAX: 714-997-4930 * Leasing@SDAssociatesProperties.com